



Canterbury Park Fact Sheet

The Business

Live Horse Racing: May through Labor Day

Simulcast Racing: 7 days a week, year round, hours varied

Canterbury Card Club: 7 days a week, 24 hours a day, 2 rooms featuring a Poker Room and the Casino Games Room

Canterbury Special Events: Year round, offering a variety of events, parties, trade shows, consumer shows and concerts

Shakopee Valley RV Park: 50 full service sites, 62 camping sites, Clubhouse with indoor pool

Corporate Information

Corporate Headquarters: 1100 Canterbury Road, Shakopee, MN 55379

Market Information: Canterbury Park Holding Corporation's common stock trades on the American Stock Exchange under the symbol ECP

The Facility

Property: 385 Acres

Grandstand: 275,000 square feet: six levels: glass-enclosed: air-conditioned

Seating capacity: 3000 outside, 4500 inside

Mutuel windows: 200 inside and 130 outside

Closed-circuit television sets: 500 +

Canterbury Card Club: 2 rooms with over 15,000 sq. ft. offering 50 tables for Poker and Casino Card Games, full service bar, Finish Line Café, Menu and Cocktail Service

Track Level: 19,875 square feet, Ubetcha Bar & Grill: 12,200 square feet

Mezzanine Level: 25,000 square feet, inside seating 1450, outside 2567

Clubhouse Level: 26,625 square feet, President's Suite seating for 75-100, Ascot Bar seating for 250

Paddock Pavilion: 18,100 square foot exhibition center

Parking: 6000 paved space; 2000 overflow unpaved space

Concessions/Catering: operated in-house, three full-service kitchens, 25 food and beverage stands



CANTERBURY PARK SPECIAL EVENTS GROUNDS & BUILDING RENTAL

RENTAL AREAS

	Rent per day for ticketed events	Rent per day for non-ticketed events
Paddock Pavilion (Grandstand) – 18,100 sq. feet	\$1,000.00	\$1,100.00
Track Level (1st Floor) - 19,875 square feet (Excluding stairways, elevators, concessions)	\$2,000.00	\$2,100.00
Ubetcha Bar & Grill (1st Floor) - 12,200 sq. feet	\$900.00	\$1,000.00
Mezzanine Level (2nd Floor) - 25,000 square feet	\$1,600.00	\$1,700.00
RENTAL PRICE IF ALL AREA'S ARE RENTED	\$5,000.00	\$5,500.00

Above rental prices include parking lot use for customers.

**Rental costs are for event days, no charge for 1 set up day and 1 tear down day, if additional set up or tear down days are needed, the cost would be half the daily rental fee, per day.

ADDITIONAL COSTS

Electric 8 X 10 booth - Standard 110	\$30.00 / booth
Closed Circuit TV with camera person	\$300.00 / hour
Finance	\$15.00 / hour
Facility Fee (if an admission fee is charged for show)	\$1.00 / adult ticket
Security during show & over night	\$23.00 / hour, per officer
Guest Services	\$15.00 / hour, per person
Table Rental	\$10.00 / table
Chair Rental	\$2.00 / per chair
Telephone Lines	\$25.00 / per line
Box Office Services	\$16.50 / per seller, \$26.50 / per supervisor



CANTERBURY PARK FACILITY MAP

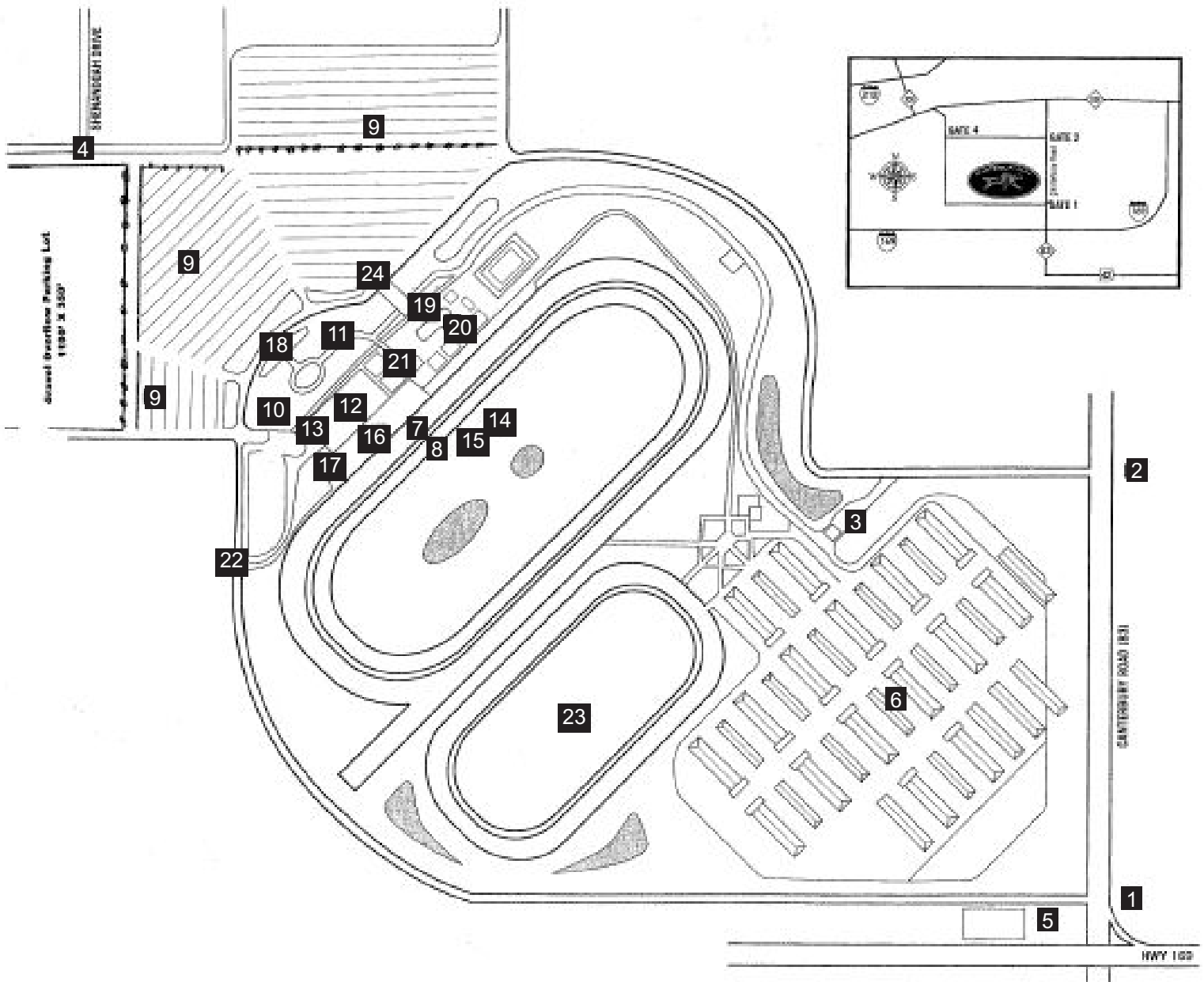

- | | | |
|-----------------------|-----------------------------|---------------------------|
| 1. Gate 1 | 9. Free Parking | 17. Wild Horse Saloon |
| 2. Gate 2 | 10. Preferred/Valet Parking | 18. Paddock Gardens |
| 3. Gate 3/Stable Gate | 11. Grandstand Entrance | 19. Shire Square |
| 4. Gate 4 | 12. Grandstand | 20. Paddock Pavilion |
| 5. Park Inn | 13. Card Club Entrance | 21. Ubetcha Bar & Grill |
| 6. Stables | 14. Tote Board | 22. Loading Dock Entrance |
| 7. Main Racetrack | 15. Finish Line | 23. Practice Track |
| 8. Turf Course | 16. Apron | 24. Shire Square Entrance |



CANTERBURY PARK PADDOCK PAVILION MAP

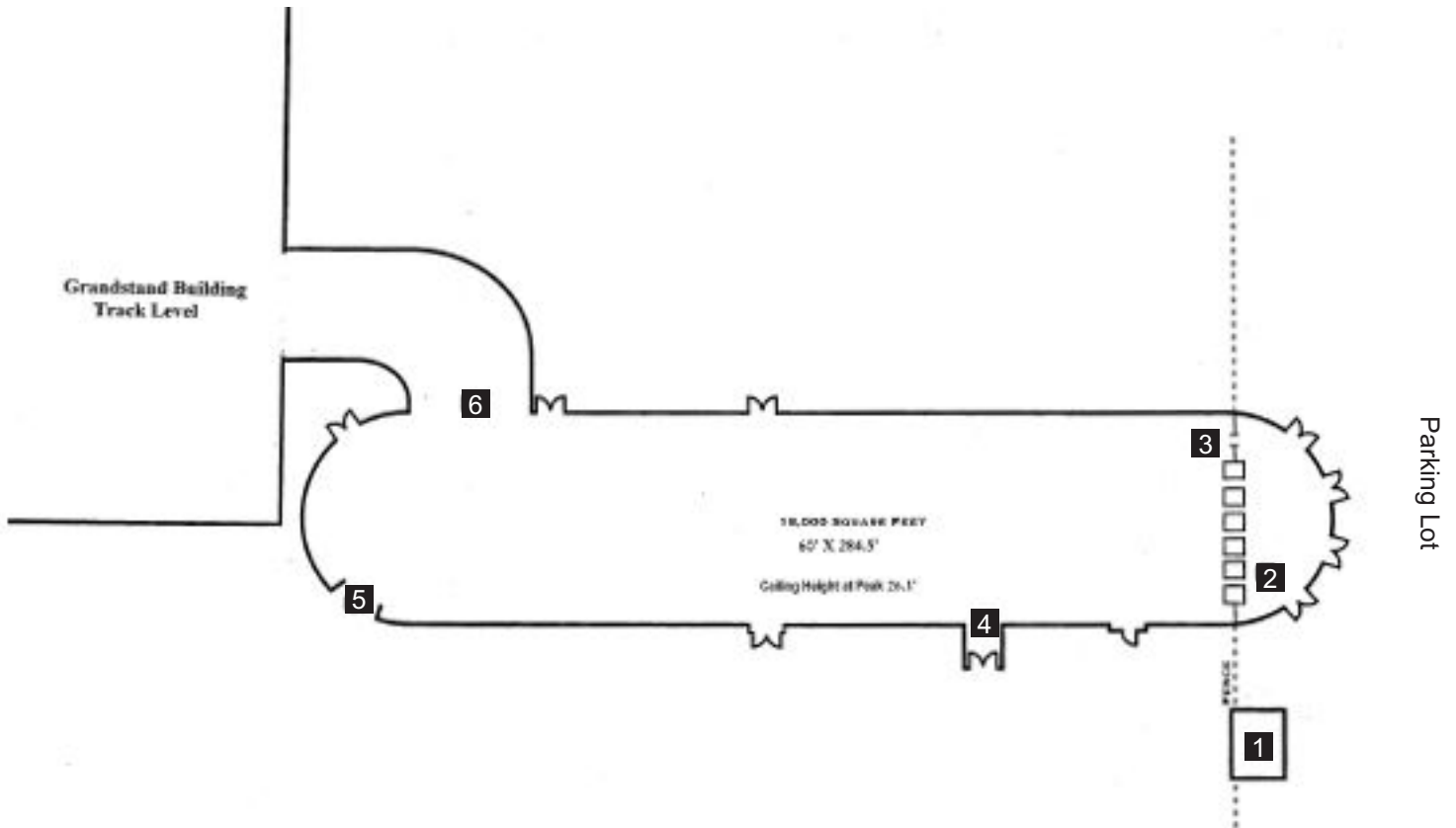

1. Ticket Office
2. Admission Booths

3. Security Gate
4. Concession Stand

5. Overhead Door
6. Grandstand Entrance



CANTERBURY PARK TRACK LEVEL MAP

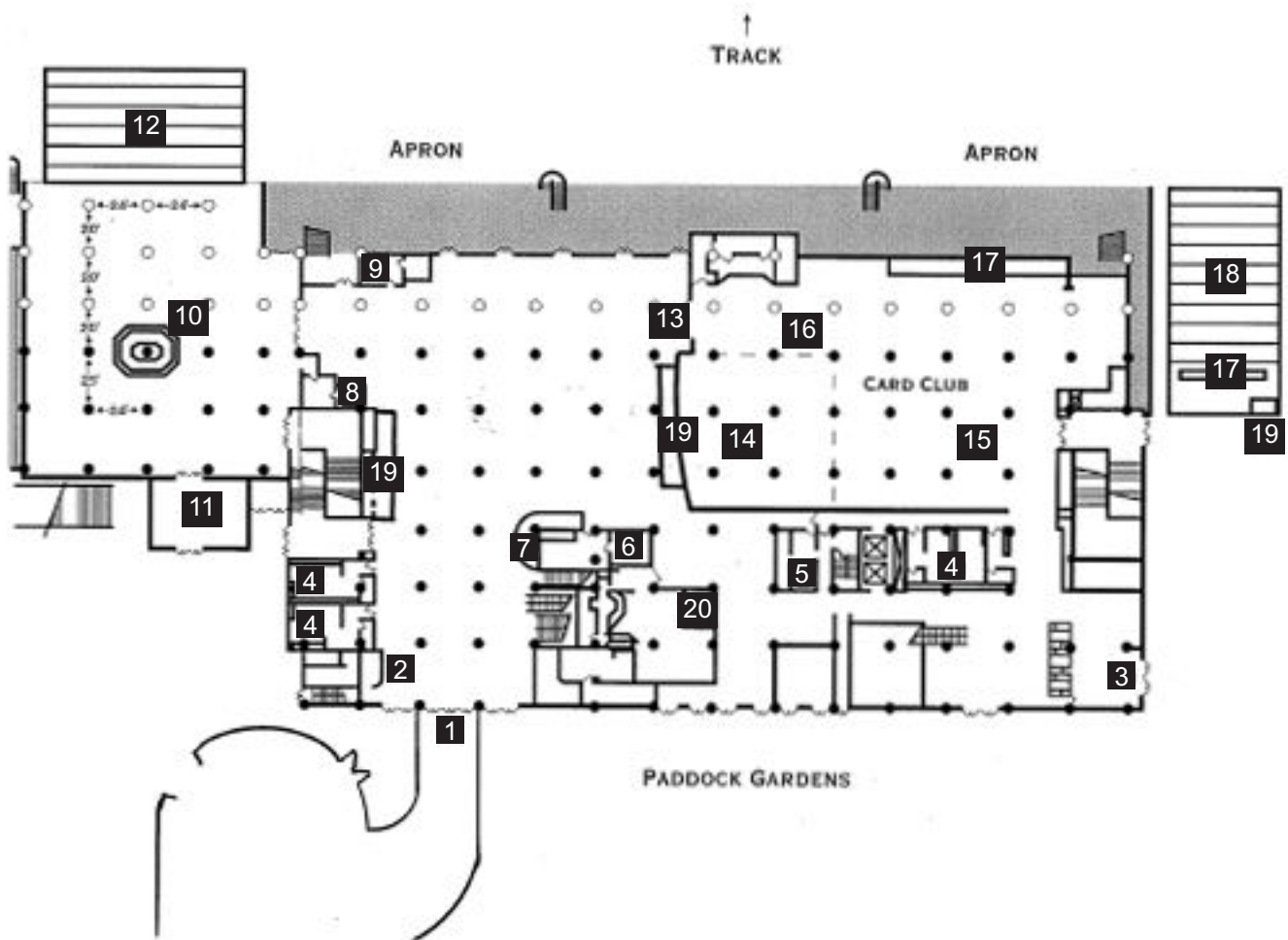

- | | | |
|------------------------------|------------------------------|------------------------------|
| 1. Grandstand Entrance | 8. Leinie's Lodge Concession | 15. Poker Room |
| 2. Information Center | 9. St. Paul Snack | 16. Food Court |
| 3. Card club/Valet Entrance | 10. Ubetcha Bar | 17. Bar |
| 4. Bathrooms | 11. Ubetcha Grill | 18. Wild Horse Saloon & Deck |
| 5. Shakopee Stand Concession | 12. Ubetcha Deck | 19. Mutuels |
| 6. Pizza n' Pasta Concession | 13. Card club Entrance | 20. Iguana Bar |
| 7. Ice Cream Concession | 14. Casino Games Room | |



CANTERBURY PARK MEZZANINE LEVEL MAP

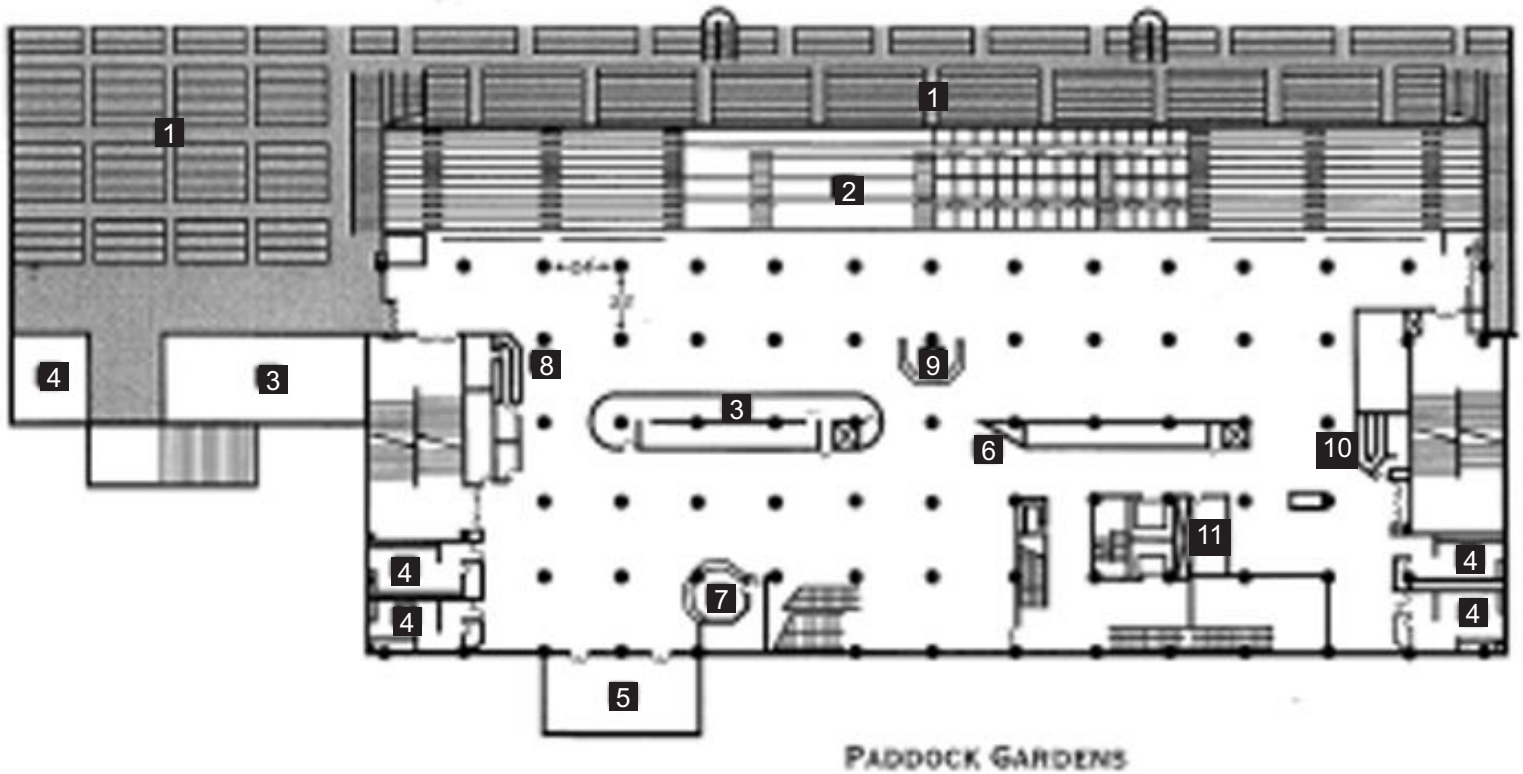

- 1. Outside Seating
- 2. Inside Seating
- 3. Mutuels
- 4. Bathrooms

- 5. Deck
- 6. Pronto Pup Concession
- 7. Canterbury Grill
- 8. Char's Pub

- 9. Horseshoe Bar
- 10. South of the Border
- 11. Canterbury Pub



INSURANCE REQUIREMENTS

Lessee agrees to carry and to pay the premiums for insurance of the types and in the limits that it deems sufficient for its protection, and during the Lease Term agrees to fulfill the following terms and conditions:

A. Lessee shall maintain a General Liability Policy and Workers' Compensation / Employers Liability Policy. The policy limits for the coverage's listed will not be less than the following:

Workers' Compensation:	MN Statutory Benefits
Employer's Liability:	\$500,000 B. I. Disease
	\$100,000 B. I. Accident
	\$100,000 B. I. Disease Each Employee
Commercial General Liability:	\$1,000,000 General Aggregate
	\$1,000,000 Products & Completed Operations
	\$1,000,000 Personal Injury
	\$1,000,000 Each Occurrence
	\$50,000 Fire Damage
Automobile Liability:	\$1,000,000 Combined Single Limit

B. Canterbury Park Holding Corporation shall be named as additional insured in Lessee's policies of insurance listed above, except Workers' Compensation.

C. Lessee shall furnish to Canterbury Park Holding Corporation proof in a form satisfactory to Canterbury of the existence of the insurance coverage's and limits required above no later than 15 days prior to any installation or occupancy of premises. (Accord certificates are satisfactory.) Failure to provide satisfactory proof of insurance shall give Canterbury the absolute right to cancel this Lease Agreement.

D. No restrictions or limitations in coverage for participant or spectators liability is allowed without express written consent from Canterbury Park.

E. Lessee hereby expressly waives and releases any cause of action or right of recovery which Lessee may have against CPHC for any loss or damage to the Lessee's Personal Property at the CPHC complex.

F. Promoter hereby expressly waives and releases any claim, cause of action or right of recovery which Promoter may have against CPHC for any loss or damage to the Promoter's Personal Property at the Facility.



-SAMPLE CONTRACT-

CANTERBURY PARK HOLDING CORPORATION FACILITY RENTAL AGREEMENT

THIS AGREEMENT is made as of DATE, by and between CANTERBURY PARK HOLDING CORPORATION ("CPHC"), P. O. Box 508, Shakopee, Minnesota 55379, Phone: (612) 445-7223, Fax: (612) 496-6400 and RENTERS NAME, ADDRESS, PHONE & FAX.

RECITALS:

CPHC is the owner of a facility located in Shakopee, Minnesota commonly known as "Canterbury Park" (the "Facility").

The Facility is conducive to and available for events open to the public.

Promoter, NAME as representative of COMPANY NAME desires to use portions of the Facility for its _____ (the "Event"), subject to the terms and conditions of this Agreement and all applicable laws and regulations.

NOW, THEREFORE, in consideration of the mutual promises, covenants and conditions contained herein, the parties mutually agree as follows:

1. Consent. Pursuant to the provisions of this Agreement, CPHC grants Promoter the right to use that portion of the Facility described and designated in paragraph 2 below for the Event (the "Space"). Promoter may subcontract use of a portion of the Space during the time period described in paragraph 3 with CPHC's prior consent, provided, that (a) Promoter is responsible for all actions of any subcontractor and (b) any agreement Promoter may have with any subcontractor shall in all respects be subject to the terms and conditions of this Agreement, and CPHC's rights hereunder.

2. Event Space. The Space defined in this Agreement shall be as follows:

To Be Defined

Additionally, CPHC grants Promoter the non-exclusive right to use the parking lot located on the Facility and any and all designated ingress and egress areas from the parking lot to the Space.

3. Period of Use. The days and hours during which Promoter shall have use of the Space are as follows:

DATES

4. Rates/Charges. The rent and other charges payable by Promoter pursuant to this Agreement are as follows:

Event Days:

Move In / Move Out:

Security:

Electric:

Facility Fee:

5. Other Terms:

A. Comp Tickets

B. Additional Services/Personnel. Additional services or personnel which are deemed reasonably necessary and mutually agreed between CPHC and Promoter will be charged to Promoter. Promoter further agrees that by arranging for any services beyond those listed in this agreement that Promoter is solely responsible for the payment of the total amount due.

C. Taxes. All applicable federal, state and local taxes and charges which may be imposed on the Event are in addition to the rent and other charges to be paid by Promoter pursuant to this Agreement, and Promoter agrees to be solely responsible for the payment of the same.

6. Cancellation. If the Event is canceled with less than thirty (30) days notice prior to the date of the Event, Promoter will pay forfeit their rent or deposit of \$_____. Additionally, in the event of any cancellation, Promoter agrees to reimburse CPHC for any reasonable and actual expenses incurred by CPHC in connection with the Event.

7. Food and Beverage. CPHC, as a licensee of food and beverages sold in and from the Facility, is responsible for the administration of the sale and service of any food, beverage, or alcoholic beverage sold in connection with the event in accordance with the laws of the State of Minnesota and the City of Shakopee. In accordance with such laws, all liquor and wine must be supplied by CPHC. No food or beverage of any kind may be sold on the property without the prior consent of CPHC. All prices for food and beverages, including liquor and wine, are subject to change prior to the Event.

8. Right to Review Publicity. CPHC shall have the right to review and approve all publicity, including, but not limited to, press releases and advertising. Specifically, but not by way of limitation, the use of Canterbury Park name and logo is expressly prohibited without the written permission of CPHC, which shall not be unreasonably withheld.

9. Licensing and Restrictions. All promoter stands must have proof of proper sales tax permits, licensing and health inspection permits prior to the start of the Event. Promoter agrees that all food items for sale or display are subject to prior approval of CPHC. Promoter agrees on behalf of itself and its subcontractors to comply with and be solely responsible for all provisions of all applicable laws regarding sales and use taxes as to Promoter's or its subcontractor's sales.

10. Damage. Promoter and its subcontractors are responsible for any and all damage to the Facility, caused by Promoter or its subcontractors including without limitation damage caused during set-up, the Event, and tear-down periods.

11. Insurance Requirements. Promoter agrees to carry and to pay the premiums for insurance of the types and for no less than the following limits, and otherwise agrees to the following terms and conditions:

A. Promoter shall maintain a General Liability Policy and Workers' Compensation/Employers Liability Policy, with policy limits for the coverages in amounts not less than the following:

Workers' Compensation:	MN Statutory Benefits
Employer's Liability:	\$ 500,000 B.I. Disease
	\$100,000 B.I. Accident

\$100,000 B.I. Disease Each Employee

Commercial General Liability: \$1,000,000 General Aggregate
 \$1,000,000 Products and Completed Operation
 \$1,000,000 Personal Injury
 \$1,000,000 Each Occurrence
 \$500,000 Fire Damage

Automobile Liability: \$1,000,000 Combined Single Limit

- B. Canterbury Park Holding Corporation shall be named as an additional insured or a loss payee, as the case may be, in each of Promoter's policies of insurance listed above, except Workers' Compensation.
 - C. Promoter shall furnish to CPHC proof in a form satisfactory to CPHC of the existence of the insurance coverages and limits required above no later than 15 days prior to any installation or occupancy of premises. (Accord certificates are satisfactory.) Failure to provide satisfactory proof of insurance shall give CPHC the absolute right to cancel this Agreement without cost or penalty to CPHC.
 - D. No restrictions or limitations in coverage for participants or spectators liability are allowed without express written consent from CPHC.
 - E. Promoter hereby expressly waives and releases any claim, cause of action or right of recovery which Promoter may have against CPHC for any loss or damage to the Promoter's Personal Property at the Facility.
12. Indemnification. Promoter hereby indemnifies and holds CPHC harmless from and against any and all claims, damages, liabilities, costs, fines, penalties and expenses, including reasonable attorneys' fees resulting from any claims or allegations of any person or entity, including but not limited to any of invitees, employees, customers, sub-contractors, or any governmental agency, which arise out of or in connection with the Promoter's acts or omissions.
13. Force Majeure. If the performance or observance of this Agreement or of any obligation hereunder is prevented, restricted or interfered with or, in the reasonable judgment of CPHC, would endanger public safety or result in material damage to the Facility by reason of any cause beyond the reasonable control of the nonperforming party, such as unavoidable and unforeseeable equipment failures, vendor delays, acts of God (such as violent storms, excessive rainfall, blizzards, or snow storms), the parties so affected shall be excused from performance or observance of this Agreement to the extent of such prevention, restriction or interference, provided, however, the party so affected shall use its best efforts to avoid or remove such causes of nonperformance or nonobservance hereunder with the utmost dispatch and observance or performance whenever such causes may be removed.
14. State of Minnesota. Promoter agrees to abide by the laws of the State of Minnesota and its regional and local political subdivisions, including, but not limited to, laws regulating pull tabs, bingo, charity fund raisers, any type of gambling equipment. All necessary permits will be required prior to show opening. CPHC reserves the right to close any booth or subcontractor who does not meet the requirements of all State, County and City ordinances.
15. Regulation by the Minnesota Racing Commission; Horse Associations. CPHC is a horse racing



CANTERBURY PARK CATERING

Whether business or social, your event at Canterbury Park means top menu selections and great service. If your group means business, we'll provide the meeting space. If your event is open to the public, we'll have the concession stands open. If you are planning a party for 50 – 1500 we can handle it all, from buffets to plated dinners. Canterbury offers full bar service. The following packages are offered during the Live Racing Season, and the Holiday Season but can be customized for any occasion. Our catering staff can work out any type of menu you desire and you will find our pricing very competitive.

Please contact our Catering Department at 952-496-6416



CANTERBURY PARK APPETIZERS

Each tray will serve approximately 20 guests.
(Recommend minimum 4 trays with dinner, 6-8 trays with appetizers only)

Dixie Wings
Served with a Dipping Sauce
\$67.00 Per Order

Buffalo Wings
Served with Bleu Cheese and Celery Sticks
\$67.00 Per Order

Barbeque Cocktail Smokies
\$40.00 Per Order

Meatballs
Served with Marinara Sauce
\$40.00 Per Order

Fresh Vegetable Tray
Served with Vegetable Dip
\$45.00 Per Tray

Fresh Fruit Tray
\$52.00 Per Tray

Deluxe Cheese Tray
Served with Crackers
\$52.00 Per Tray

Basket of Snack Mix
\$6.00 Per Pound

Popcorn, Snack Mix and Potato Chips
Served with Chip Dip
\$1.50 Per Person

Shrimp Cocktail
Served with Cocktail Sauce and Lemons
Market Value

Prices include tax and gratuity.



CANTERBURY PARK BUFFET OPTIONS

Deli Buffet

Slow Roasted Beef and Smoked BBQ Pork, Cole Slaw, Potato Salad, Baked Beans, Potato Chips and Sandwich Toppings. Served with Iced Tea, Lemonade and Coffee.

\$17.95 Per Person (Includes Tax & Service Charge)

Picnic Buffet

Hot Dogs, Bratwurst and Sloppy Joe's, Baked Beans, Potato Chips and Cole Slaw. Served with Iced Tea, Lemonade and Coffee.

\$14.95 Per Person (Includes Tax & Service Charge)

Grill Buffet

Char-broiled Hamburgers, Chicken Breast and Bratwurst, Cole Slaw, Potato Salad, Baked Beans, Potato Chips and Sandwich Toppings. Served with Iced Tea, Lemonade and Coffee.

\$17.95 per person (Includes Tax & Service Charge)

UBETCHA! Buffet

BBQ Chicken, Sliced Roast Beef, Parsley Buttered Potatoes, Creamy Cole Slaw, Watermelon Wedges, Homemade Apple Crisp and Dinner Rolls. Served with Coffee, Iced Tea and Lemonade.

\$14.95 per person (Includes Tax & Service Charge)

The Starting Gate

Homemade Lasagna, Pasta Primavera (Alfredo Sauce, Vegetables and Noodles), Chicken Parmesan, Caesar Salad, Italian Blend of Vegetables, Bread Sticks. Served with Iced Tea, Lemonade and Coffee.

\$17.95 per person (Includes Tax & Service Charge)

The Home Stretch

Chef Carved Prime Rib of Beef served with Aujus and Horseradish Sauce, Chicken Supreme, Tossed Greens with Assorted Dressings, Parsley Buttered Potatoes, Seasonal Vegetables and Dinner Rolls. Served with Iced Tea, Lemonade and Coffee.

\$27.95 per person (Includes Tax & Service Charge)

The Finish Line

Chef Carved Beef Tenderloin served with Béarnaise Sauce, Shrimp Scampi, Caesar Salad, Chef's Blend Vegetables, Baked Potato and Dinner Rolls. Served with Iced Tea, Lemonade and Coffee.

\$35.95 per person (Includes Tax & Service Charge)



Soup & Sandwich Buffet

(Build your own sandwich w/2 Soups)

Sliced Ham, Turkey & Roast Beef

Assorted Cheeses & Breads

Lettuce, Tomato, Onions, Pickles, Mustard, Mayo & Horseradish Sauce

Potato Chips

Choice of 1: Creamy Cole Slaw, Potato Salad or Pasta Salad

Choice of 2: Chicken Noodle, Beer Cheese, Chicken Wild Rice, Beef Noodle, Vegetable Beef,

Chicken Noodle or Mild Chili

Served with Lemonade & Coffee

\$13.95 per person (Includes tax & Service Charge)



CANTERBURY PARK DESSERTS

U Carrot Cake \$3.00

Apple Crisp \$2.25

Chocolate Cake \$3.50

Cheese Cake \$3.25
New York style with Berry Topping

Cookies \$7.50 per dozen
Assorted Flavors

Brownies \$12.75 per dozen

Lemon Berry Jazz Bars \$13.00 per dozen
Prices include tax and gratuity.

CANTERBURY PARK FUN GROUP OPTIONS

Betting Seminar \$20.00
Private Seminars available. Subject to availability.

Betting Vouchers \$2.00 and up

Canterbury Currency
Good at any concession stand or bar location.

Posters
Advertise your group's outing to improve attendance.

Host Bar
Drink tickets available.
15% gratuity will be added to all host bars.

GROUP SALES INFORMATION

Canterbury Park is the perfect place to host company parties, meetings, or events. And, our facility can handle groups of 50 to 500 or more year-round. So, if you're planning a corporate event, make it fun and unique, call our Catering Sales Team at 952-496-6416.



CANTERBURY PARK BANQUET POLICIES

GUARANTEE

Final count of guaranteed guests must be received no later than seven days prior to the scheduled function. A 5% variance permitted with notification 48 hours prior to your event. No refunds will be issued for any changes made within 48 hours prior to your scheduled function.

METHOD OF PAYMENT

Final payment must be paid in full 48 hours in advance unless being guaranteed with a credit card or other arrangements have been made. A non-refundable 50% is required to secure your reservation date.

FOOD

All food items must be supplied and prepared by Canterbury Park. The customer may not remove food from the premises due to license restrictions. No food or beverage of any kind will be permitted to be brought into our group eating areas with the exception of specialty cakes.

BEVERAGE

Canterbury Park, a licensee, is responsible for the administration of the sale and service of alcoholic beverages in accordance with the State of Minnesota liquor statutes. It is a policy, therefore, that all liquor, beer and soft drinks must be supplied by Canterbury Park. A valid ID needed to purchase all alcohol and tobacco. Valid MN Drivers License, MN ID card, passport or Military ID.

CANCELLATION POLICY

If cancellation of your function becomes necessary, a written notification must be received at least 30 days prior to your event to avoid a penalty over and above your deposit.



SHAKOPEE SERVICES

HOTELS

CANTERBURY INN
1244 Canterbury Road
Shakopee, MN 55379
952-445-3644 / 877-291-0622
175 Guest Rooms
Indoor Pool/Whirlpool/Sauna
Two Restaurants/Nightclub

AMERICINN
1251 E. 1st Ave.
Shakopee, MN 55379
952-445-5074 / 800-634-3444
55 Guest Rooms
Whirlpool/Sauna
Free Continental Breakfast

BUDGET HOST
1181 E. 1st Ave
Shakopee, MN 55379
952-445-9120 / 800-BUD-HOST
34 Guest Rooms
Cable TV
Free Continental Toast Bar

COMFORT INN
4601 W. Hwy 13
Savage, MN 55378
952-894-6124 / 800-228-5150
75 Guest Rooms
Cable TV
Indoor Pool/Whirlpool
Free Continental Breakfast

COUNTRY INN & SUITES
1204 Ramsey St.
Shakopee, MN 55379
952-445-0020 / 800-456-4000
63 Guest Rooms
Specialty Suites
Free Continental Breakfast
Indoor Pool/Whirlpool

HOLIDAY INN EXPRESS
511 S. Marschall Road
Shakopee, MN 55379
952-445-9779 / 800-Holiday
66 Guest Rooms
Jacuzzi Suites
Free Continental Breakfast
Indoor Pool / Whirlpool

SUPER 8 MOTEL
581 So. Marschall Road
Shakopee, MN 55379
952-445-4221 / 800-800-8000
70 Guest Rooms
Cable TV
Indoor Pool/Whirlpool/Sauna
Free Continental Breakfast

CAMPGROUNDS
Minneapolis SW KOA
Jordan, MN 952-492-6440

Shakopee Valley RV & Campgrounds
Shakopee, MN 952-445-7313

Town & Country Campground
Savage, MN 952-445-1756

RESTAURANTS

Panache' Bread Company/Restaurant/Deli
1561 East 1st Ave / 952-445-2228

Dangerfields Restaurant
1583 East 1st Ave / 952-445-2245

Pablo's Mexican Restaurant
230 S Lewis St / 952-445-9218

Dragon Café (Chinese)
576 S Marschall Rd / 952-445-9615

Wampachs
126 1st Ave / 952-445-2721

Lion's Tap
Eden Prairie / 952-934-5299

Axel's Steakhouse
Chanhassen / 952-934-9340

Turtles Bar & Grill
132 1st Ave / 952-445-9668

HOSPITAL

St. Francis Medical Center / 5 Miles
Full Service Hospital
Urgent Care Center

AMBULANCE SERVICE

Allina

MISC

Shakopee Chamber of Commerce &
Shakopee Convention & Visitors Bureau
Carol Schultz, Director
952-445-1660

GAS STATIONS

Super America – 1 block
1195 Canterbury Road / 952-233-0395

Holiday – 3 miles
444 East 1st St. / 952-445-4450

Texaco – 2 miles
807 1st Ave / 952-445-2478